

# Puget Sound COVID-19 Pooled Testing Protocols Faculty/Staff Instructions

## How To Collect and Submit Your Sample

**Step: 1** **DO NOT** eat, drink, smoke, chew gum, or brush your teeth at least **30 minutes** prior to testing. **DO NOT** use mouthwash for at least **two hours** prior to testing.

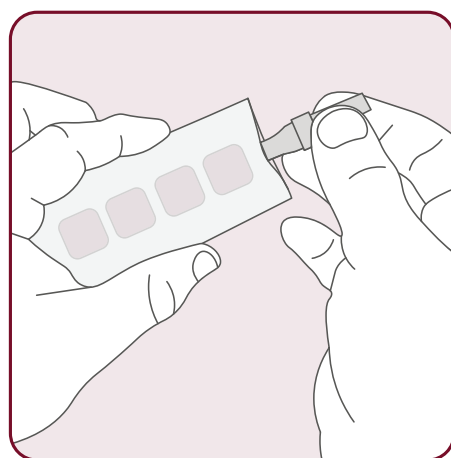

### Step: 2

Open the straw pouch and remove the straw.

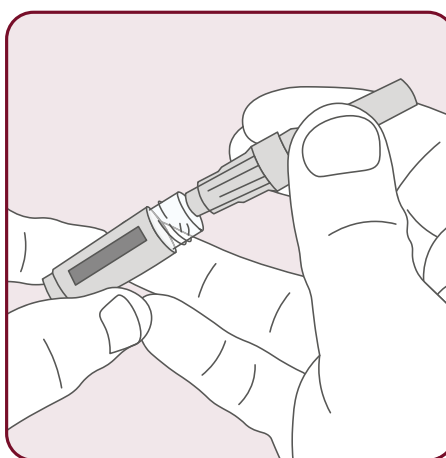

### Step: 3

Unscrew the tube cap and insert the narrow end of the straw into the tube.

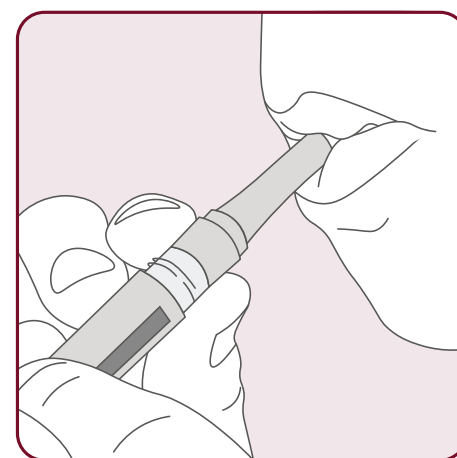

### Step: 4

Pool saliva in your mouth and let it fall through straw into the tube. Do not blow forcefully to avoid bubbles.

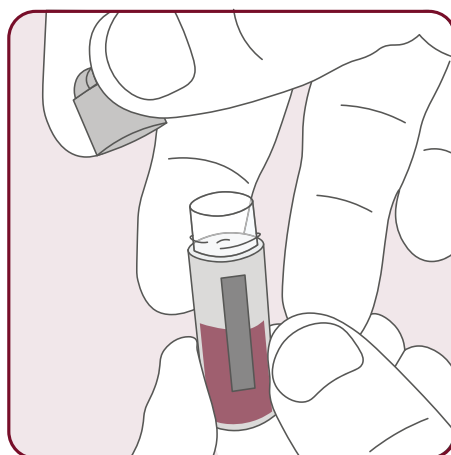

### Step: 5

Make sure the tube is filled at least halfway, then remove and discard the straw and securely cap the tube.

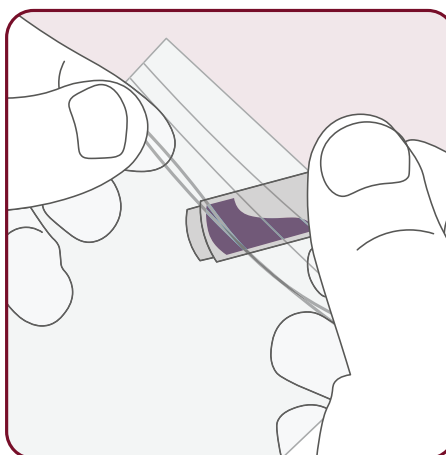

### Step: 6

Clean the tube with the alcohol wipe provided, place it into the bag, and seal the bag. **Legibly write your name and campus ID number on the label** in your kit and apply it securely to the bag.

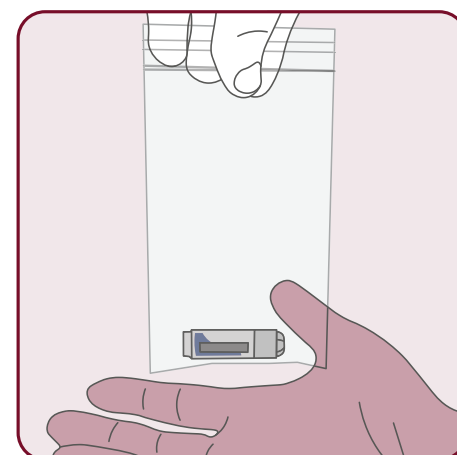

### Step: 7

Drop your sealed and labeled sample at the **Faculty/Staff Drop-off** in the testing pavilion, Monday–Friday, 8:30 a.m.–6 p.m. If you do not work during this time, make arrangements to have a department delegate deliver your sample for you.

